

WILLIAMS TOWNSHIP PARK

1080 W. MIDLAND RD AUBURN MI BAY COUNTY

EXCERISE STATIONS

- | | |
|-------------------------|-------------------------|
| ① SWING FOR HANDICAPPED | ⑧ FITNESS LADDER (TALL) |
| ② FITNESS LADDER (LOW) | ⑨ LEG LIFT |
| ③ INCLINED RING CLIMBER | ⑩ CLIMBING POLE |
| ④ PARALLEL BARS | ⑪ LOG WALL |
| ⑤ TRIPLE CHINNING BARS | ⑫ LEG STRETCH |
| ⑥ SIT-UP BENCH | ⑬ LADDER WALL |
| ⑦ DOUBLE TRAPEZE SWING | ⑭ LOGJAM CLIMBER |

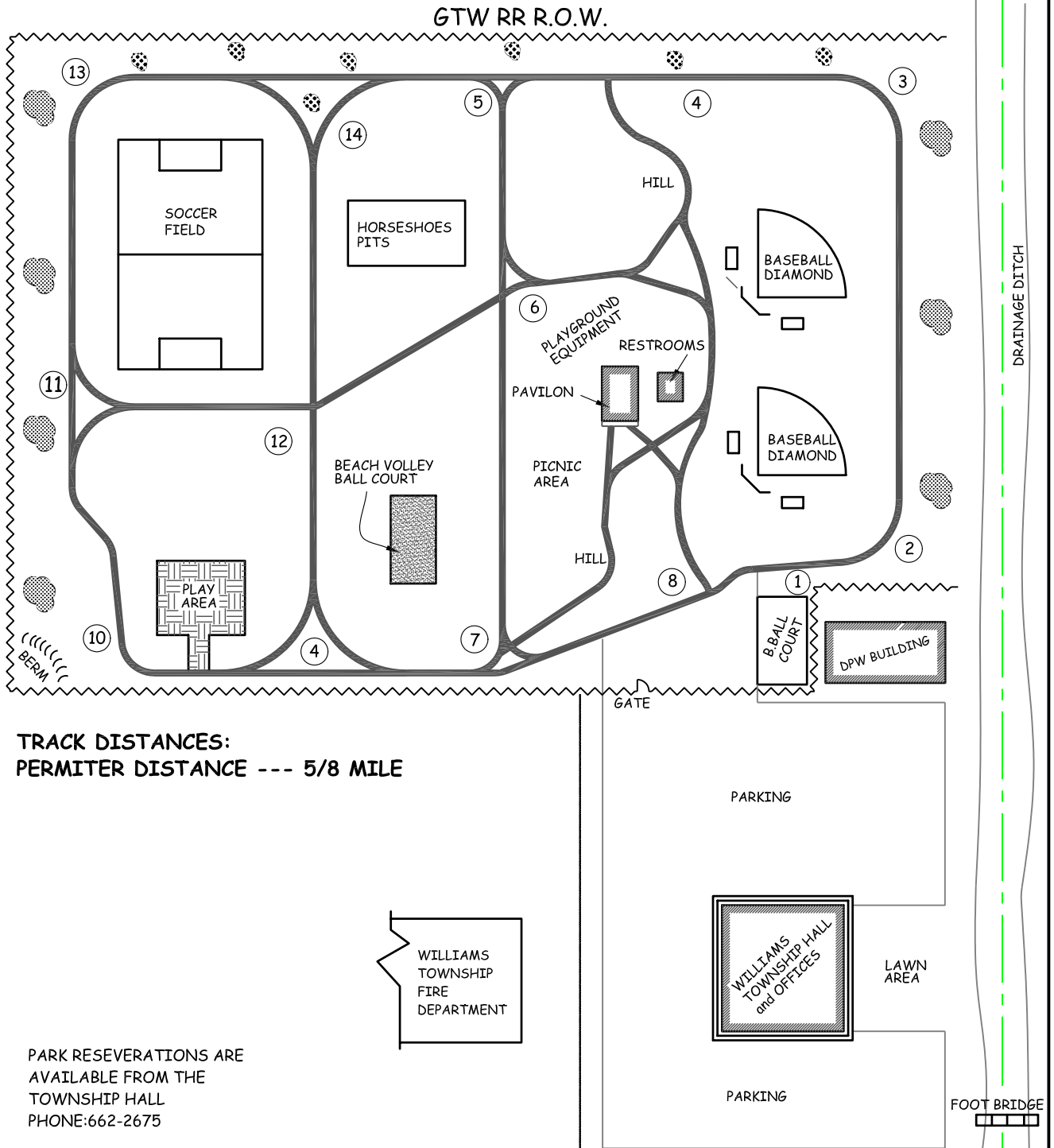

TRACK DISTANCES:
PERMETER DISTANCE --- 5/8 MILE

PARK RESEVERATIONS ARE
 AVAILABLE FROM THE
 TOWNSHIP HALL
 PHONE:662-2675

WILLIAMS
 TOWNSHIP
 FIRE
 DEPARTMENT

WILLIAMS
 TOWNSHIP HALL
 and OFFICES

FOOT BRIDGE